

G7020A

CUTTING GRINDER

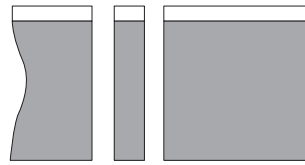

→ Cutting

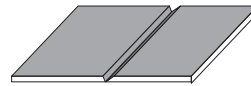

→ Half Cutting

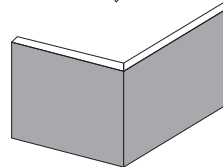

→ Side Polished

❖ Data

WEIGHT	83.0kg (185lb)
BODY SIZE	600 W x 480 D x 870 H / 24" X 19" X 34"

(Single Phase 220V / 60HZ(50Hz)) : Transformer Included

❖ Functions

- ▶ Cuts and polishes by moving the table back and forth
- ▶ Can perform full cuts and half cuts
- ▶ Cutting distance is set accurately with digital scale

❖ Optional for Half Cutting and fine Grinding

- ▶ Diamond wheel
- ▶ Digital scale
- ▶ Stone Cutting Wheel

